

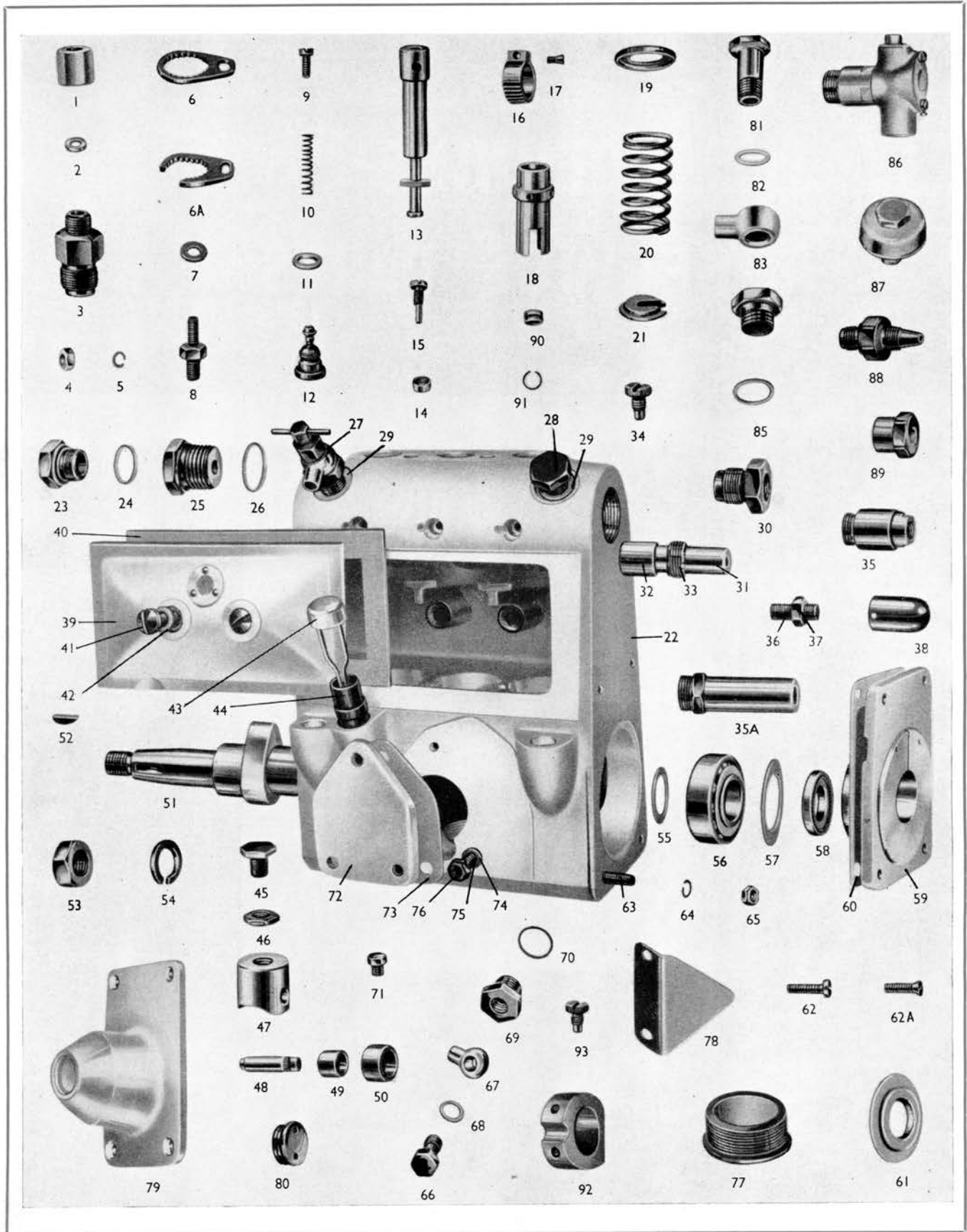

GENUINE SERVICE PARTS



**BPE 1, 2, 3, 5 & 8B
FUEL PUMPS**





INDEX

BPE1B, 2B, 3B, 5B & 8B BASIC STANDARD PARTS STANDARD MODELS

	Page		Page
BPE1B .. 100	6	BPE3B .. 400, 400/3, 410, 410/3, 420 & 420/3	7
BPE2B .. 100, 110 & 120	6	BPE5B .. 300, 300/3, 310, 310/3, 320 & 320/3	7
BPE2B .. 200, 210 & 220	6	BPE5B .. 400, 400/3, 410, 410/3, 420 & 420/3	7
BPE2B .. 300, 300/3, 310, 310/3, 320 & 320/3	6	BPE8B .. 300, 300/3, 310, 310/3, 320 & 320/3	7
BPE2B .. 400, 400/3, 410, 410/3, 420 & 420/3	6	BPE8B .. 400, 400/3, 410, 410/3, 420 & 420/3	7
BPE3B .. 300, 300/3, 310, 310/3, 320 & 320/3	6		

SPECIAL MODELS

	Page		Page
BPE1B100 .. 100S69	8	BPE3B100 .. 300/3, 400/3S525	9
BPE1B100 .. 100S86	9	BPE3B100 .. 300/3S529	11
BPE1B70 .. 100S463	9	BPE3B70 .. 300/3, 400/3S533	11
BPE1B50/100 .. 100S6025	13	BPE3B70 .. 300/3, 400/3S536	11
BPE1B100 .. 100S6040	13	BPE3B100 .. 320/3, 420/3S593	11
BPE1B50 .. 100S6041	13	BPE3B70 .. 300/3, 400/3S600	11
BPE1B90 .. 100S6268	16	BPE3B70 .. 300/3, 400/3S613	11
BPE1B60 .. 101S6629	18	BPE3B100 .. 300, 300/3, 400, 400/3S679	12
BPE2B70/75/80/90 .. 100S23	8	BPE3B100 .. 300/3, 400/3S687	12
BPE2B60 .. 100S49	8	BPE3B80 .. 300/3, 400/3S6096	13
BPE2B100 .. 100S54	8	BPE3B65 .. 300/3, 400/3S6128	14
BPE2B70/100 .. 100/200S59	8	BPE3B65 .. 300/3, 400/3S6150	14
BPE2B80 .. 100/110/200S86	9	BPE3B90 .. 320/3, 420/3S6168X	14
BPE2B75 .. 320S86X	9	BPE3B90 .. 320/3, 420/3S6168XEL	14
BPE2B70 .. 100/200S463	9	BPE3B90 .. 320/3, 420/3S6185X	14
BPE2B70 .. 100/200S533	11	BPE3B80/90 .. 320/3S6239XEL	15
BPE2B70 .. 100/200S536	11	BPE3B100 .. 420/3S6239XEL	15
BPE2B70 .. 100/200S613	11	BPE3B70 .. 400/3S6263	15
BPE2B75 .. 100S635	12	BPE3B70/100 .. 400/3S6265	15
BPE2B100 .. 100S649	12	BPE3B90 .. 300/3S6268	16
BPE2B100 .. 100S6040	13	BPE3B70 .. 300/3, 400/3S6424	17
BPE2B75 .. 320, 320/3S6091	13	BPE3B75 .. 300/3, 400/3S6471	18
BPE2B75 .. 320S6091EL	13	BPE3B75 .. 300/3, 400/3S6472	18
BPE2B100 .. 420, 420/3S6204	14	BPE3B100 .. 320/420S6519	18
BPE2B90 .. 100S6209X	15	BPE3B100 .. 420/3S6572EL	18
BPE2B70 .. 100S6214X	15	BPE5B100 .. 300/3, 400/3S54	8
BPE2B70/100 .. 300/3S6266	16	BPE5B100 .. 300/3S69	8
BPE2B90 .. 100S6268	16	BPE5B80/100 .. 300/3, 400/3S86	9
BPE2B70 .. 100S6269	16	BPE5B70 .. 300/400S463	9
BPE2B100 .. 420S6272	16	BPE5B100 .. 300/3, 400/3S593	11
BPE2B70 .. 100/110S6304	17	BPE5B75 .. 300/3, 400/3S634	12
BPE2B90 .. 100S6352XE	17	BPE5B100 .. 300, 300/3, 400, 400/3S679	12
BPE2B70 .. 100/200S6424	17	BPE5B80 .. 300, 300/3, 400/3S686	12
BPE2B75 .. 100S6470	17	BPE5B100 .. 400/3, 420, 420/3S6232XEL	15
BPE2B75 .. 100S6471	18	BPE8B70 .. 300/3, 400/3S463	9
BPE3B100 .. 300/3, 400/3S54	8	BPE8B90 .. 310/3S6176EL	14
BPE3B65 .. 300/3, 400S69	8	BPE8B90 .. 310/3S6287EL	16
BPE3B100 .. 300/3, 400/3S86	9	BPE8B80 .. 320/410S6312E	17
BPE3B70 .. 300/400S463	9	BPE8B80 .. 310/420S6362E	17



BPEIB, 2B, 3B, 5B & 8B STANDARD FUEL PUMP PARTS

ILLUS. No.	DESCRIPTION OF PART	PART No.
1	NUT, delivery union	7097-47
2	WASHER, delivery union	†
3	HOLDER, delivery valve	†
4	NUT, locking plate stud	NU5-2Y1
5	WASHER, spring, for locking plate stud... ..	5293-57
6	PLATE, locking (3) (BPEI, 2, 3, 5 & 8B)	7009-203
6A	PLATE, locking (3) (BPE3 & 5B—additional)	7009-203A
7	WASHER, plain, for locking plate stud	5339-662
8	STUD (long hexagon), for locking plate (BPE2, 3, 5 & 8B)	5335-573
8	STUD (short hexagon), for locking plate (BPEI, 3 & 5B)	5335-573A
10	SPRING, delivery valve	†
11	JOINT, delivery valve	5339-862
12	VALVE, delivery	†
13	ELEMENT	†
14	CUP, sealing barrel locking screw	7010-548
15	SCREW, barrel locking	7010-549
16	QUADRANT	7010-570A
17	SCREW, for quadrant	5335-195
18	SLEEVE, control	7010-3
19	PLATE, spring, upper	7009-6
20	SPRING, plunger	†
21	PLATE, spring, lower	†
22	HOUSING	†
23	PLUG, inlet closing... ..	7010-18A
24	JOINT, for inlet closing plug	†
25	CONNECTION, inlet	†
26	JOINT, for inlet connection	†
28	SCREW, air vent	7010-296
29	JOINT, for air vent screw	5339-383
30	UNION, inlet	†
31	ROD, control	†
32	BUSH, control rod	7010-184
33	RING, locking control rod bush	7010-185
34	SCREW, locating control rod: (For pumps fitted with mechanical governor)	5335-445
34	(For pneumatic or non-governor models)	7022-22
35	SLEEVE, control rod	†
36	SCREW, for control rod sleeve	†
37	NUT, locking control rod adjusting screw	†
38	COVER, control rod sleeve	†
39	COVER, inspection, complete	†
40	Gasket, inspection cover	†
41	Screw, inspection cover... ..	7060-15
42	Washer, inspection cover screw	5339-258
43	DIPSTICK	†
44	BUSH, dipstick	†
—	TAPPET, complete	†
45	Screw, tappet	†
46	Locknut	†
47	Guide	†

continued—

† Part number varies—refer to individual type model for appropriate part number.



BPEIB, 2B, 3B, 5B & 8B STANDARD FUEL PUMP PARTS—continued

ILLUS. No.	DESCRIPTION OF PART	PART No.
48	Pin, roller	†
49	Bush, roller	†
50	Roller	†
51	CAMSHAFT	†
52	KEY, camshaft	NK1-6
53	NUT, camshaft	5330-96
54	WASHER, spring, camshaft	5001-40
55	SHIM, camshaft, .008"	7010-32
55	SHIM, camshaft, .010"	7010-33A
55	SHIM, camshaft, .012"	7010-33
55	SHIM, camshaft, 0.35 mm	7010-34A
55	SHIM, camshaft, 0.4 mm	7010-34
55	SHIM, camshaft, 0.8 mm (use on W & Y only when Timken bearing is used)	7010-32A
56	BEARING, ball (use with 5-7.5 mm elements on Q, R, S, T, U & V models)	NC6-3
56	BEARING, roller (use with 8-10 mm elements on Q, R, S, T, U & V models)	NC5-2
56	BEARING, taper roller (all W & Y models)	NC8-6
57	SHIM, oil seal, 2.5 mm	7097-303
57	SHIM, oil seal, 2.0 mm (Q, R, S, T, U & V models only)	7097-303A
57	SHIM, oil seal, 0.5 mm	7010-357
58	SEAL, oil	7097-166
59	ENDPLATE	†
60	GASKET, endplate	7010-409
61	SEAL, oil (additional with flyweight governor—Q, R, S, T, U & V models only)	7010-372
63	STUD, endplate fixing	†
64	WASHER, spring, for endplate stud	†
65	NUT, for endplate stud	†
66	STUD, oil drain connection	†
67	BANJO, oil drain	†
68	JOINT, for oil drain stud or plug	†
69	BODY, oil drain	†
70	JOINT, for oil drain body	NW5-39
71	PLUG, oil drain	†
72	COVER, blanking	†
73	GASKET, for blanking cover or feed pump (Q, S, U & W models)	7010-417
73	(R, T, V & Y models)	7010-418
74	STUD, for blanking cover or feed pump	7097-20B
75	WASHER, spring, for stud	5293-57
76	NUT, for stud	NU7-11Y1
77	PLUG, base closing	7010-153
92	BEARING, centre (BPE8B .. models only)	7069-7
93	SCREW, locating centre bearing (BPE8B .. models only)	7022-22A

† Part number varies—refer to individual type model for appropriate part number.



DESCRIPTION	BPEIB . . R, T, V & Y 100	BPE2B . . Q, S, U & W 100, 110 & 120	BPE2B . . Q, S, U & W 200, 210 & 220	BPE2B . . R, T, V & Y 300, 300/3, 310, 310/3, 320 & 320/3	BPE2B . . R, T, V & Y 400, 400/3, 410, 410/3, 420 & 420/3
WASHER, delivery union ...	5339-138 2	§	§	§	§
HOLDER, delivery valve ...	† 3	† 3	† 3	† 3	† 3
SPRING, delivery valve ...	† 10	† 10	† 10	† 10	† 10
VALVE, delivery ...	† 12	† 12	† 12	† 12	† 12
ELEMENT (100, 110, 200, 210, 300, 310, 400 & 410 assemblies) ...	20 mm pitch LH helix 13	20 mm pitch LH helix 13	20 mm pitch LH helix 13	20 mm pitch LH helix 13	20 mm pitch LH helix 13
(120, 220, 320 & 420 assemblies) ...	† —	20 mm pitch RH helix 13	20 mm pitch RH helix 13	20 mm pitch RH helix 13	20 mm pitch RH helix 13
SPRING, plunger ...	7010-9 20	§	§	§	§
PLATE, spring, lower ...	7009-7 21	§	§	§	§
HOUSING (Q, S, U & W) ...	—	7016-17 22	7016-17 22	—	—
(R, T, V & Y) ...	7060-2 22	—	—	7016-35 22	7016-35 22
JOINT, inlet closing plug ...	5339-174 24	§	§	§	§
CONNECTION, inlet ...	7010-46 25	§	§	§	§
JOINT, inlet connection ...	5339-263 26	§	§	§	§
UNION, inlet ...	7009-18 30	§	§	§	§
ROD, control (100, 200, 300 & 400 assemblies) (110, 120, 210, 220, 310, 320, 410 & 420 assemblies) ...	7060-4 31	7016-6 31	7016-6 31	7016-6 31	7016-6 31
SLEEVE, control rod ...	—	7016-6B 31	7016-6B 31	7016-6B 31	7016-6B 31
SCREW, control rod sleeve ...	—	7010-509 35	7010-509 35	7010-509 35	7010-509 35
NUT, locking control rod screw ...	—	7033-205 36	7033-205 36	7033-205 36	7033-205 36
COVER, control rod sleeve ...	—	5330-136 37	5330-136 37	5330-136 37	5330-136 37
INSPECTION COVER ASSEMBLY ...	7010-385A 39	7033-204 38	7033-204 38	7033-204 38	7033-204 38
Gasket ...	7010-16 40	7010-385B 39	7010-385B 39	7016-38 39	7016-38 39
DIPSTICK ...	7010-326 43	7016-32 40	7016-32 40	7016-32 40	7016-32 40
BUSH, dipstick ...	7010-158 44	§	§	—	—
TAPPET, complete ...	7010-507 —	§	§	§	§
Screw, tappet ...	7010-15 45	§	§	§	§
Locknut ...	5330-87 46	§	§	§	§
Guide ...	7010-595 47	§	§	§	§
Pin, roller... ...	7010-172 48	§	§	§	§
Bush, roller ...	7010-11 49	§	§	§	§
Roller ...	7010-17 50	§	§	§	§
CAMSHAFT (Q, S, U & W) (R, T, V & W) ...	—	7016-1 51	7016-2 51	—	—
ENDPLATE, ball race (Q, R, S, T, U & V) ...	7060-3 51	—	—	7016-41 51	7016-42 51
ENDPLATE, roller race (Q, R, S, T, U & V) ...	7010-555 59	§	§	§	§
ENDPLATE, taper roller race (W & Y) ...	7010-550 59	§	§	§	§
STUD, endplate ...	7010-597 59	§	§	§	§
WASHER, spring, for stud ...	5335-537 63	§	§	§	§
NUT, for endplate stud ...	5293-57 64	§	§	§	§
JOINT, oil drain plug ...	7095-34 65	§	§	§	§
BODY, oil drain ...	5339-543 68	§	§	§	§
PLUG, oil drain ...	7033-133 69	§	§	§	§
COVER, blanking (. . /3 models) ...	7092-246 71	§	§	§	§
	—	—	—	7010-449 72	7010-449 72

† Part numbers vary according to element size fitted. See page 19 for table of alternatives.
§ This denotes the same part number as column 1.

SERVICE PARTS



**FUEL
PUMPS
BPEI, 2, 3,
5 & 8B**

DESCRIPTION	BPE3B . . Q, R, S, T, U, V, W & Y 300, 300/3, 310, 310/3, 320 & 320/3	BPE3B . . Q, R, S, T, U, V, W & Y 400, 400/3, 410, 410/3, 420 & 420/3	BPE5B . . Q, R, S, T, U, V, W & Y 300, 300/3, 310, 310/3, 320 & 320/3	BPE5B . . Q, R, S, T, U, V, W & Y 400, 400/3, 410, 410/3, 420 & 420/3	BPE8B . . Q, R, S, T, U, V, W & Y 300, 300/3, 310, 310/3, 320, 320/3, 400, 400/3, 410, 410/3, 420 & 420/3
WASHER, delivery union ...	5339-138	§	§	§	§
HOLDER, delivery valve ...	† 3	† 3	† 3	† 3	† 3
SPRING, delivery valve ...	† 10	† 10	† 10	† 10	† 10
VALVE, delivery ...	† 12	† 12	† 12	† 12	† 12
ELEMENT (300, 310, 400 & 410 assemblies)	† 20 mm pitch	20 mm pitch	20 mm pitch	20 mm pitch	20 mm pitch
	LH helix 13	LH helix 13	LH helix 13	LH helix 13	LH helix 13
(320 & 420 assemblies)	† 20 mm pitch	20 mm pitch	20 mm pitch	20 mm pitch	20 mm pitch
	RH helix 13	RH helix 13	RH helix 13	RH helix 13	RH helix 13
SPRING, plunger ...	7010-9	§	§	§	§
PLATE, spring, lower ...	7009-7	§	§	§	§
HOUSING (Q, S, U & W) ...	7012-32	§	7012-33	7012-33	7069-2
(R, T, V & Y) ...	7012-32C	§	7012-33B	7012-33B	7069-2A
JOINT, inlet closing plug ...	5339-174	§	§	§	§
CONNECTION, inlet ...	7010-46	§	§	§	§
JOINT, inlet connection ...	5339-263	§	§	§	§
UNION, inlet ...	7009-18	§	§	§	§
ROD, control (300 & 400 assemblies)	7017-6	§	7018-5	7018-5	7069-4
(310, 320, 410 & 420 assemblies)	7017-6B	§	7018-5A	7018-5A	7069-4A
SLEEVE, control rod ...	110, 120, 210, 7010-509	§	§	§	§
SCREW, control rod sleeve ...	220, 310, 320, 7033-205	§	§	§	§
NUT, locking control rod screw ...	410 & 420 5330-136	§	§	§	§
COVER, control rod sleeve ...	assemblies 7033-204	§	§	§	§
INSPECTION COVER ASSEMBLY	7010-385C	§	7010-385E	7010-385E	7010-385G
Gasket ...	7010-27	§	7018-16	7018-16	7069-14
DIPSTICK ...	7010-326	§	§	§	§
BUSH, dipstick ...	7010-158	§	§	§	§
TAPPET, complete ...	7010-507	§	§	§	§
Screw, tappet ...	7010-15	§	§	§	§
Locknut ...	5330-87	§	§	§	§
Guide ...	7010-595	§	§	§	§
Pin, roller ...	7010-172	§	§	§	§
Bush, roller ...	7010-11	§	§	§	§
Roller ...	7010-17	§	§	§	§
CAMSHAFT (Q, S, U & W)	7017-1	7017-2	7018-2	7018-6	7069-3
(R, T, V & Y) ...	7017-29	7017-30	7018-18	7018-19	7069-15
ENDPLATE, ball race (Q, R, S, T, U & V)	7010-555	§	§	§	§
ENDPLATE, roller race (Q, R, S, T, U & V)	7010-550	§	§	§	§
ENDPLATE, taper roller race (W & Y)	7010-597	§	§	§	§
STUD, endplate ...	5335-537	§	§	§	§
WASHER, spring, for stud ...	5293-57	§	§	§	§
NUT, for endplate stud ...	7095-34	§	§	§	§
JOINT, oil drain plug ...	5339-543	§	§	§	§
BODY, oil drain ...	7033-133	§	§	§	§
PLUG, oil drain ...	7092-246	§	—	—	—
COVER, blanking (Q, S, U & W .../3 models)	7010-93	§	§	§	§
(R, T, V & Y .../3 models)	7010-449	§	§	§	§

† Part numbers vary according to element size fitted. See page 19 for table of alternatives.
§ This denotes the same part number as column 1.



DESCRIPTION	BPE2B70 BPE2B75 BPE2B80 BPE2B90 Q, S, U & W 100 S23		BPE2B60 Q, S, U & W 100 S49		BPE2B100 BPE3B100 BPE5B100 Q, S, U & W 100, 300/3 & 400/3 S54		BPE2B70 BPE2B100 Q, S, U & W 100 & 200 S59		BPE1B100 R, T, V & Y 100 S69		BPE3B65 BPE3B80 BPE5B100 Q, S, U & W 300/3 & 400 S69		
WASHER, delivery union ...	5339-138	2	§		§		§		§		§		
HOLDER (6-8 mm elements) ...	7010-542	3	§		§		§		§		§		
(9-10 mm elements) ...	7010-545	3	—		—		—		—		—		
SPRING (6-8 mm elements) ...	7032-7	10	§		§		§		§		§		
(9-10 mm elements) ...	7010-146	10	—		—		—		—		—		
VALVE (6-8 mm elements) ...	7118-229	12	§		§		§		§		§		
(9-10 mm elements) ...	7010-586	12	—		—		—		—		—		
ELEMENT, 6-0 mm ...	—			7010-562M	13	—	—		—		—		
6-5 mm ...	—			—		—	—		—		7010-562C	13	
7-0 mm ...	7010-562P	13	—		—	—	—		—		—		
7-5 mm ...	7010-562Q	13	—		—	—	—		—		—		
8-0 mm ...	7010-562R	13	—		—	—	—		—		7010-562F	13	
9-0 mm ...	7010-562S	13	—		—	—	—		—		—		
10-0 mm ...	—			—		7010-562U	13	7010-562U	13	7010-562J	13	7010-562J	13
SPRING, plunger ...	7010-9	20	§		§		§		§		§		
PLATE, spring, lower ...	7009-7	21	§		§		§		§		§		
HOUSING (BPE1B) ...	—		—		—		—		7060-2	22	—		
(BPE2B) ...	7016-7	22	§		7016-17	22	7016-17A	22	—		—		
(BPE3B) ...	—		—		7012-32	22	—		—		7012-32	22	
(BPE5B) ...	—		—		7012-33	23	—		—		7012-33	22	
JOINT, inlet closing plug ...	5339-174	24	§		§		§		§		§		
CONNECTION, inlet ...	7010-46	25	§		§		§		§		§		
JOINT, inlet connection ...	5339-263	26	§		§		§		§		§		
AIR VENT COCK ...	—		—		7010-617A	27	—		—		—		
UNION, inlet ...	7009-18	30	§		§		§		§		§		
ROD, control (BPE1B) ...	—		—		—		—		7060-4	31	—		
(BPE2B) ...	7016-6	31	§		§		§		—		—		
(BPE3B) ...	—		—		7017-6	31	—		—		7017-6	31	
(BPE5B) ...	—		—		7018-5	31	—		—		7018-5	31	
INSPECTION COVER ASSY.: (BPE1B) ...	—		—		—		—		7010-385A	39	—		
(BPE2B) ...	7010-385B	39	§		§		§		—		—		
(BPE3B) ...	—		—		7010-385C	39	—		—		7010-385C	39	
(BPE5B) ...	—		—		7010-385E	39	—		—		7010-385E	39	
Gasket, cover (BPE1B) ...	—		—		—		—		7010-16	40	—		
(BPE2B) ...	7016-32	40	§		§		§		—		—		
(BPE3B) ...	—		—		7017-27	40	—		—		7017-27	40	
(BPE5B) ...	—		—		7018-16	40	—		—		7018-16	40	
DIPSTICK ...	7010-326	43	§		§		§		§		§		
BUSH, dipstick ...	7010-158	44	§		§		§		§		§		
TAPPET, complete ...	7010-507	—	§		7010-507A	—	7010-507	—	7010-507	—	7010-507	—	
Screw, tappet ...	7010-15	45	§		7010-15A	45	7010-15	45	7010-15	45	7010-15	45	
Locknut ...	5330-87	46	§		§		§		§		§		
Guide ...	7010-595	47	§		§		§		§		§		
Pin, for roller ...	7010-172	48	§		§		§		§		§		
Bush, for roller ...	7010-11	49	§		§		§		§		§		
Roller ...	7010-17	50	§		§		§		§		§		
CAMSHAFT: (BPE1B ..) ...	—		—		—		—		7060-3	51	—		
(BPE2B .. 100) ...	7016-14	51	7016-29	51	7016-21	51	7016-1	51	—		—		
(BPE2B .. 200) ...	—		—		—		7016-2	51	—		—		
(BPE3B .. 300/3) ...	—		—		7017-18	51	—		—		7017-1	51	
(BPE3B .. 400, 400/3) ...	—		—		7017-14	51	—		—		7017-2	51	
(BPE5B .. 300/3) ...	—		—		7018-10	51	—		—		7018-2	51	
(BPE5B .. 400/3) ...	—		—		7018-9	51	—		—		—		

continued—

§ This denotes the same part number as column 1.

SERVICE PARTS



**FUEL
PUMPS
BPEI, 2, 3,
5 & 8B**

DESCRIPTION —continued	BPE2B70 BPE2B75 BPE2B80 BPE2B90 Q, S, U & W 100 S23		BPE2B60 Q, S, U & W 100 S49		BPE2B100 BPE3B100 BPE5B100 Q, S, U & W 100, 300/3 & 400/3 S54		BPE2B70 BPE2B100 Q, S, U & W 100 & 200 S59		BPE1B100 R, T, V & Y 100 S69		BPE3B65 BPE3B80 BPE5B100 Q, S, U & W 300/3 & 400 S69	
	ENDPLATE, ball race ...	7010-555	59	§		§		§		§		§
roller race ...	7010-550	59	§		§		§		§		§	
taper roller race†	7010-597	59	§		§		§		§		§	
STUD, endplate... ..	5335-537	63	§		§		§		§		§	
WASHER, spring, for stud ...	5293-57	64	§		§		§		§		§	
NUT, for endplate stud ...	7095-34	65	§		§		§		§		§	
STUD, oil drain (BPE5B only)	—		—		7008-188	66	—		—		7008-188	66
BANJO, oil drain (BPE5B only)	—		—		NAI-2	67	—		—		NAI-2	67
JOINT, oil drain	5339-543	68	§		§		§		§		§	
BODY, oil drain (BPEI, 2 & 3B)	7033-133	69	§		§		§		§		§	
PLUG, oil drain (BPEI, 2 & 3B)	7092-246	71	§		—		§		§		§	
COVER, blanking (. . /3 models)	—		—		7010-93	72	—		—		7010-93	72

† W & Y models only.

DESCRIPTION	BPE1B100 R, T, V & Y 100 S86		BPE2B80 BPE3B100 BPE5B100 Q, S, U & W 100, 110, 200, 300/3 & 400/3 S86		BPE2B75 R, T, V & Y 320 S86X		BPE1B70 R, T, V & Y 100 S463		BPE2B70 BPE3B70 BPE5B70 BPE8B70 Q, S, U & W 100, 200, 300, & 400 S463		BPE3B100 Q, S, U & W 300/3 & 400/3 S525	
	WASHER, delivery union ...	5339-138	2	§		§		§		§		§
HOLDER (7-8 mm elements) ...	—		7010-542	3	7010-544	3	7010-542	3	7010-542	3	—	
(10 mm elements) ...	7010-545	3	§		—		—		—		7010-542	3
SPRING (7-8 mm elements) ...	—		7032-7	10	7009-208	10	7032-7	10	7032-7	10	—	
(10 mm elements) ...	7010-146	10	§		—		—		—		7032-7	10
VALVE (7-8 mm elements) ...	—		7118-229	12	7010-586F	12	7118-229	12	7118-229	12	—	
(10 mm elements) ...	7010-586	12	§		—		—		—		7118-229	12
ELEMENT, 7.0 mm	—		—		—		7010-562P	15	7010-562P	13	—	
7.5 mm	—		—		7010-562Q	13	—		—		—	
8.0 mm	—		7010-562R	13	—		—		—		—	
10.0 mm	7010-562U	13	§		—		—		—		—	
SPRING, plunger	7010-9	20	§		—		—		—		—	
PLATE, spring, lower	7009-7	21	§		—		—		—		—	
HOUSING (BPE1B)	7060-2	22	—		—		—		—		—	
(BPE2B)	—		7016-17	22	7016-35	22	—		7016-17	22	—	
(BPE3B)	—		7012-32	22	—		—		7012-32	22	7012-32A	22
(BPE5B)	—		7012-33	22	—		—		7012-33	22	—	
(BPE8B)	—		—		—		—		7069-2	22	—	
JOINT, inlet closing plug ...	5339-174	24	§		§		§		§		§	
CONNECTION, inlet	7010-46	25	§		§		§		§		§	
JOINT, inlet connection ...	5339-263	26	§		§		§		§		§	
AIR VENT COCK	—		—		—		—		—		7010-617A	27
UNION, inlet	7009-18	30	§		§		§		§		§	
ROD, control (BPE1B)	7060-4	31	—		—		—		—		—	
(BPE2B)	—		7016-6	31	7016-6B	31	—		7016-6	31	—	
(BPE3B)	—		7017-6	31	—		—		7017-6	31	7017-6	31
(BPE5B)	—		7018-5	31	—		—		7018-5	31	—	
(BPE8B)	—		—		—		—		7069-4	31	—	

§ This denotes the same part number as column 1.



DESCRIPTION —continued	BPEIB100 R, T, V & Y 100		BPE2B80 BPE3B100 BPE5B100 Q, S, U & W 100, 110, 200, 300/3 & 400/3		BPE2B75 R, T, V & Y 320		BPEIB70 R, T, V & Y 100		BPE2B70 BPE3B70 BPE5B70 BPE8B70 Q, S, U & W 100, 200, 300, 300/3, 400 & 400/3 S463		BPE3B100 Q, S, U & W 300/3 & 400/3	
	S86		S86		S86X		S463		S463		S525	
SLEEVE, control rod ...	—		—		7010-509	35	—		—		—	
SCREW, control rod sleeve ...	—		—		7033-205	36	—		—		—	
NUT, control sleeve screw ...	—		—		5330-136	37	—		—		—	
COVER, control rod sleeve ...	—		—		7032-204	38	—		—		—	
INSPECTION COVER ASSY.:												
(BPEIB) ...	7010-385A	39	—		—		§		—		—	
(BPE2B) ...	—		7010-385B	39	7016-38	39	—		7010-385B	39	—	
(BPE3B) ...	—		7010-385C	39	—		—		7010-385C	39	7010-385C	39
(BPE5B) ...	—		7010-385E	39	—		—		7010-385E	39	—	
(BPE8B) ...	—		—		—		—		7010-385G	39	—	
Gasket, cover (BPEIB) ...	7010-16	40	—		—		§		—		—	
(BPE2B) ...	—		7016-32	40	7016-32	40	—		7016-32	40	—	
(BPE3B) ...	—		7071-27	40	—		—		7017-27	40	7017-27	40
(BPE5B) ...	—		7018-16	40	—		—		7018-16	40	—	
(BPE8B) ...	—		—		—		—		7069-14	40	—	
DIPSTICK ...	7010-326	43	§		—		§		§		§	
BUSH, dipstick ...	7010-158	44	§		—		§		§		§	
TAPPET, complete ...	7010-507	—	§		§		§		§		7010-507A	—
Screw, tappet ...	7010-15	45	§		§		§		§		7010-15A	45
Locknut ...	5330-87	46	§		§		§		§		§	
Guide ...	7010-595	47	§		§		§		§		§	
Pin, for roller ...	7010-172	48	§		§		§		§		§	
Bush, for roller ...	7010-11	49	§		§		§		§		§	
Roller ...	7010-17	50	§		§		§		§		§	
CAMSHAFT:												
(BPEIB ..)	7060-31	51	—		—		7060-3	51	—		—	
(BPE2B .. 100 & 110)	—		7016-21	51	—		—		7016-1	51	—	
(BPE2B .. 200)	—		7016-33	51	—		—		7016-2	51	—	
(BPE2B .. 320)	—		—		7016-40	51	—		—		—	
(BPE3B .. 300/3)	—		7017-18	51	—		—		7017-1	51	7017-1	51
(BPE3B .. 400/3)	—		7017-14	51	—		—		7017-2	51	7017-2	51
(BPE5B .. 300/3)	—		7018-10	51	—		—		7018-2	51	—	
(BPE5B .. 400/3)	—		7018-9	51	—		—		7018-6	51	—	
(BPE8B .. 300/3, 400/3)	—		—		—		—		7069-3	51	—	
ENDPLATE, ball race ...	7010-555	59	§		§		§		§		§	
ENDPLATE, roller race ...	7010-550	59	§		§		§		§		§	
ENDPLATE, taper roller race†	7010-597	59	§		§		§		§		§	
STUD, endplate ...	5335-537	63	§		§		§		§		§	
WASHER, spring, for stud ...	5293-57	64	§		§		§		§		§	
NUT, for endplate stud ...	7095-34	65	§		§		§		§		§	
STUD, oil drain (BPE5B & 8B)	—		7008-188	66	—		—		7008-188	66	—	
BANJO, oil drain (BPE5B & 8B)	—		NAI-2	67	—		—		NAI-2	67	—	
JOINT, oil drain ...	5339-543	68	§		§		§		§		§	
BODY, oil drain (BPEI, 2 & 3B)	7033-133	69	§		§		§		§		§	
PLUG, oil drain (BPEI, 2 & 3B)	7092-246	71	§		§		§		§		7023-125	71
COVER, blanking (. . /3 models)	—		7010-93	72	—		—		7010-93	72	7010-93	72
CONNECTION, inlet ...	—		—		—		7027-13	81	7027-13	81	—	
JOINT, inlet connection ...	—		—		—		7017-17	82	7027-17	82	—	
BANJO, connection ...	—		—		—		NAI-10	83	NAI-10	83	—	
ADAPTOR, inlet ...	—		—		—		7027-12	84	7027-12	84	—	
JOINT, adaptor ...	—		—		—		5339-174	85	5339-174	85	—	

† W & Y models only.

§ This denotes the same part number as column 1.

SERVICE PARTS



FUEL PUMPS
BPEI, 2, 3,
5 & 8B

DESCRIPTION	BPE3B100 Q, S, U & W 300/3		BPE2B70 BPE3B70 Q, S, U & W 100, 200, 300/3 & 400/3		BPE2B70 BPE3B70 Q, S, U & W 100, 200, 300/3 & 400/3		BPE3B100 BPE5B100 Q, S, U & W 300/3, 400/3, 320/3 & 420/3		BPE3B70 Q, S, U & W 300/3 & 400/3		BPE2B70 BPE3B70 Q, S, U & W 100, 200, 300/3 & 400/3	
	S529		S533		S536		S593		S600		S613	
WASHER, delivery union ...	5339-138	2	§		§		§		§		§	
HOLDER, delivery valve ...	7010-545	3	7010-542	3	7010-542	3	7010-545	3	7010-542	3	7010-542	3
SPRING, delivery valve ...	7010-146	10	7032-7	10	7032-7	10	7010-146	10	7032-7	10	7032-7	10
VALVE, delivery ...	7010-586	12	7118-229	12	7118-229	12	7010-586	12	7118-229	12	7118-229	12
ELEMENT ...	7010-562J	13	7010-562P	13	7010-562P	13	7010-562J	13	7010-562P	13	7010-562P	13
SPRING, plunger ...	7010-9	20	§		§		§		§		§	
PLATE, spring, lower ...	7009-7	21	§		§		§		§		§	
HOUSING (BPE2B) ...	—		7016-17	22	7016-17	22	—		—		7016-17	22
(BPE3B) ...	7012-32	22	§		§		§		§		§	
(BPE5B) ...	—		—		—		7012-33	22	—		—	
JOINT, inlet closing plug ...	5339-174	24	§		§		§		§		§	
CONNECTION, inlet ...	7010-46	25	§		§		§		§		§	
JOINT, inlet connection ...	5339-263	26	§		§		§		§		§	
AIR VENT COCK ...	7010-617A	27	—		—		§		§		§	
UNION, inlet ...	7009-18	30	—		—		§		§		§	
ROD, control (BPE2B) ...	—		7016-6A	31	7016-6	31	—		—		7016-6	31
(BPE3B) ...	7017-6	31	7017-6A	31	7017-6	31	7017-6B	31	7017-6	31	7017-6	31
(BPE5B) ...	—		—		—		7018-5	31	—		—	
SLEEVE, control rod ...	—		—		—		7010-509*	35	—		—	
SCREW, c/rod adjusting ...	—		—		—		7033-205*	36	—		—	
NUT, locking adjusting screw...	—		—		—		5330-136*	37	—		—	
CAP, sleeve ...	—		—		—		7033-204*	38	—		—	
INSPECTION COVER ASSY.:												
(BPE2B) ...	—		7010-385B	39	7010-385B	39	—		—		7010-385B	39
(BPE3B) ...	7010-385C	39	§		§		§		§		§	
(BPE5B) ...	—		—		—		7010-385E	39	—		—	
Gasket, cover (BPE2B) ...	—		7016-32	40	7016-32	40	—		—		7016-32	40
(BPE3B) ...	7017-27	40	§		§		§		§		§	
(BPE5B) ...	—		—		—		7018-16	40	—		—	
DIPSTICK ...	7010-326	43	§		§		§		§		§	
BUSH, dipstick ...	7010-158	44	§		§		§		§		§	
TAPPET, complete ...	7010-507	—	§		§		7010-507A	—	7010-507	—	7010-507	—
Screw, tappet ...	7010-15	45	§		§		7010-15A	45	7010-15	45	7010-15	45
Locknut ...	5330-87	46	§		§		§		§		§	
Guide ...	7010-595	47	§		§		§		§		§	
Pin, for roller ...	7010-172	48	§		§		§		§		§	
Bush, for roller ...	7010-11	49	§		§		§		§		§	
Roller ...	7010-17	50	§		§		§		§		§	
CAMSHAFT:												
(BPE2B .. 100) ...	—		7016-1	51	7016-1	51	—		—		7016-1	51
(BPE2B .. 200) ...	—		7016-2	51	7016-2	51	—		—		7016-2	51
(BPE3B .. 300/3, 320/3) ...	7017-10	51	7017-1	51	7017-1	51	7017-18	51	7017-1	51	7017-1	51
(BPE3B .. 400/3, 420/3) ...	—		7017-2	51	7017-2	51	7017-14	51	7017-2	51	7017-2	51
(BPE5B .. 300/3) ...	—		—		—		7018-10	51	—		—	
(BPE5B .. 400/3) ...	—		—		—		7018-9	51	—		—	
ENDPLATE, ball race ...	7010-555	59	§		§		§		§		§	
ENDPLATE, roller race ...	7010-550	59	§		§		§		§		§	
ENDPLATE, taper roller race†	7010-597	59	§		§		§		§		§	
SCREW, securing end cover ...	—		—		—		—		—		NS75-18Y	62A
STUD, endplate...	5335-537	63	§		§		§		§		§	
WASHER, spring for stud ...	5293-57	64	§		§		§		§		§	
NUT, for endplate stud ...	7095-34	65	§		§		§		§		§	
STUD, oil drain (BPE5B only) ...	—		—		—		7008-188	66	—		—	
BANJO, oil drain (BPE5B only) ...	—		—		—		NAI-2	67	—		—	
JOINT, oil drain ...	5339-543	68	§		§		§		§		§	
BODY, oil drain (BPE2 & 3B) ...	7033-133	69	§		§		§		§		§	
PLUG, oil drain (BPE2 & 3B) ...	7092-246	71	§		§		§		§		§	
COVER, blanking (.../3 models)	7010-93	72	§		§		§		§		§	
COVER, end ...	—		—		—		—		—		7010-26	79
CONNECTION, inlet ...	7022-19	81	—		—		—		—		—	
JOINT, inlet connection ...	5339-260	82	—		—		—		—		—	
BANJO, connection ...	NAI-13	83	—		—		—		—		—	

† W & Y Models. *BPE3B . .
§ This denotes the same part number as column 1.



DESCRIPTION	BPE5B75 Q, S, U & W 300/3 & 400/3		BPE2B75 Q, S, U & W 100		BPE2B100 Q, S, U & W 100		BPE3B100 BPE5B100 Q, S, U & W 300, 300/3, 400 & 400/3		BPE5B80 Q, S, U & W 300, 300/3 & 400/3		BPE3B100 Q, S, U & W 300/3 & 400/3	
	S634		S635		S649		S679		S686		S687	
WASHER, delivery union ...	5339-138	2	§	§	§	§	§	§	§	§	§	§
HOLDER, delivery valve ...	7010-542	3	§	§	7010-545	3	7010-545	3	7010-542	3	7010-545	3
SPRING, delivery valve ...	7032-7	10	§	§	7010-146	10	7010-146	10	7032-7	10	7010-146	10
VALVE, delivery ...	7118-229	12	§	§	7010-586	12	7010-586	12	7118-229	12	7010-586	12
ELEMENT ...	7010-502Q	13	§	§	7010-562J	13	7010-562J	13	7010-562R	13	7010-562U	13
SPRING, plunger ...	7010-9	20	§	§	§	§	§	§	§	§	§	§
PLATE, spring, lower ...	7009-7	21	§	§	§	§	§	§	§	§	§	§
HOUSING (BPE2B) ...	—	—	7016-17B	22	7016-17	22	—	—	—	—	—	—
(BPE3B) ...	—	—	—	—	—	—	7012-32	22	—	—	7012-32	22
(BPE5B) ...	7012-33A	22	—	—	—	—	7012-33	22	7012-33	22	—	—
JOINT, inlet closing plug ...	5339-174	24	§	§	§	§	§	§	§	§	§	§
CONNECTION, inlet ...	7010-46	25	§	§	§	§	§	§	§	§	§	§
JOINT, inlet connection ...	5339-263	26	§	§	§	§	§	§	§	§	§	§
AIR VENT COCK ...	—	—	—	—	—	—	7010-617A	27	7010-617A	27	—	—
UNION, inlet ...	7009-18	30	§	§	§	§	§	§	§	§	§	§
ROD, control (BPE2B) ...	—	—	7016-6	31	7016-6	31	—	—	—	—	—	—
(BPE3B) ...	—	—	—	—	—	—	7017-6	31	—	—	7017-6	31
(BPE5B) ...	7018-5	31	—	—	—	—	§	§	§	§	—	—
INSPECTION COVER ASSY.:												
(BPE2B) ...	—	—	7010-385B	39	7010-385B	39	—	—	—	—	—	—
(BPE3B) ...	—	—	—	—	—	—	7010-385C	39	—	—	7010-385C	39
(BPE5B) ...	7010-385E	39	—	—	—	—	§	§	§	§	—	—
Gasket, cover (BPE2B) ...	—	—	7016-32	40	7016-32	40	—	—	—	—	—	—
(BPE3B) ...	—	—	—	—	—	—	7017-27	40	—	—	7017-27	40
(BPE5B) ...	7018-16	40	—	—	—	—	§	§	§	§	—	—
DIPSTICK ...	7010-326	43	§	§	§	§	§	§	§	§	§	§
BUSH, dipstick ...	7010-158	44	§	§	§	§	§	§	§	§	§	§
TAPPET, complete ...	7010-507	—	§	§	§	§	§	§	§	§	§	§
Screw, tappet ...	7010-15	45	§	§	§	§	§	§	§	§	§	§
Locknut ...	5330-87	46	§	§	§	§	§	§	§	§	§	§
Guide ...	7010-595	47	§	§	§	§	§	§	§	§	§	§
Pin, for roller ...	7010-172	48	§	§	§	§	§	§	§	§	§	§
Bush, for roller ...	7010-11	49	§	§	§	§	§	§	§	§	§	§
Roller ...	7010-17	50	§	§	§	§	§	§	§	§	§	§
CAMSHAFT:												
(BPE2B .. 100) ...	—	—	7016-14	51	7016-21	51	—	—	—	—	—	—
(BPE3B .. 300/3) ...	—	—	—	—	—	—	7017-18	51	—	—	7017-1	51
(BPE3B .. 400/3) ...	—	—	—	—	—	—	7017-14	51	—	—	7017-2	51
(BPE5B .. 300, 300/3) ...	7018-2	51	—	—	—	—	7018-10	51	7018-13	51	—	—
(BPE5B .. 400, 400/3) ...	7018-6	51	—	—	—	—	7018-9	51	7018-14	51	—	—
ENDPLATE, ball race ...	7010-555	59	§	§	§	§	§	§	§	§	§	§
ENDPLATE, roller race ...	7010-550	59	§	§	§	§	§	§	§	§	§	§
ENDPLATE, taper roller race†	7010-597	59	§	§	§	§	§	§	§	§	§	§
STUD, endplate ...	5335-537	63	§	§	§	§	§	§	§	§	§	§
WASHER, spring, for stud ...	5293-57	64	§	§	§	§	§	§	§	§	§	§
NUT, for endplate stud ...	7095-34	65	§	§	§	§	§	§	§	§	§	§
STUD, oil drain (BPE5B only) ...	7008-188	66	—	—	—	—	§	§	§	§	—	—
BANJO, oil drain (BPE5B only)	NAI-2	67	—	—	—	—	§	§	§	§	—	—
JOINT, oil drain ...	5339-543	68	§	§	§	§	§	§	§	§	§	§
BODY, oil drain (BPEI, 2 & 3B)	—	—	7092-246	69	7092-246	69	7092-246	69	—	—	7092-246	69
PLUG, oil drain (BPEI, 2 & 3B)	—	—	7010-453	71	7010-453	71	7010-453	71	—	—	7010-453	71
COVER, blanking (.../3 models)	7010-93	72	—	—	—	—	§	§	§	§	§	§

† W & Y models.

§ This denotes the same part number as column I.

SERVICE PARTS



**FUEL
PUMPS
BPE1, 2, 3,
5 & 8B**

DESCRIPTION	BPE1B50 BPE1B100 R, T, V & Y 100 S6025		BPE1B100 R, T, V & Y 100 S6040		BPE2B100 Q, S, U & W 100 S6040		BPE1B50 R, T, V & Y 100 S6041		BPE2B75 R, T, V & Y 320 & 320/3 S6091 S6091EL		BPE3B80 Q, S, U & W 300/3 & 400/3 S6096	
WASHER, delivery union ...	5339-138	2	§		§		§		§		§	
HOLDER (5-8 mm elements) ...	7010-542	3	—		—		§		§		§	
(10 mm elements) ...	7010-545	3	§		§		—		—		—	
SPRING (5-8 mm elements) ...	7032-7	10	—		—		§		§		§	
(10 mm elements) ...	7010-146	10	§		§		—		—		—	
VALVE (5-8 mm elements) ...	7118-229	12	—		—		7010-585A	12	7118-229	12	7118-229	12
(10 mm elements) ...	7010-586	12	7010-586A	12	7010-586A	12	—		—		—	
ELEMENT, 5-0 mm ...	7010-562K	13	—		—		§		—		—	
7-5 mm ...	—		—		—		—		7010-562Q	13	—	
8-0 mm ...	—		—		—		—		—		7010-562R	13
10-0 mm ...	7010-562U	13	§		§		—		—		—	
SPRING, plunger ...	7010-9	20	7010-407	20	7010-407	20	7010-9	20	7010-9	20	7010-9	20
PLATE, spring, lower ...	7009-7	21	7009-184	21	7009-184	21	7009-7	21	7009-7	21	7009-7	21
HOUSING ...	7060-2	22	§		7016-17	22	7060-2A	22	7016-35	22	7012-32B	22
JOINT, inlet closing plug ...	5339-174	24	§		§		§		§		§	
CONNECTION, inlet ...	7010-46	25	§		§		§		§		§	
JOINT, inlet connection ...	5339-263	26	§		§		§		§		§	
AIR VENT COCK ...	—		—		—		—		—		7010-617A	27
UNION, inlet ...	7009-18	30	§		§		§		§		§	
ROD, control ...	7060-4	31	§		7016-6	31	7060-4	31	7016-6B	31	7017-6	31
SLEEVE, control rod ...	—		—		—		—		7010-509†	35	—	
SCREW, control rod sleeve ...	—		—		—		—		7033-205†	36	—	
NUT, control sleeve screw ...	—		—		—		—		5330-136‡	37	—	
COVER, control rod sleeve ...	—		—		—		—		7033-204‡	38	—	
INSPECTION COVER ASSY. ...	7010-385A	39	§		7010-385B	39	7010A-385A	39	7016-38	39	7010-385C	39
Gasket, cover ...	7010-16	40	§		7016-32	—	7010-16	40	7016-32	40	7010-27	40
DIPSTICK ...	7010-326	43	§		§		§		—		§	
BUSH, dipstick ...	7010-158	44	§		§		§		—		§	
TAPPET, complete ...	7010-507	—	7060-29	—	7060-29	—	7010-507	—	7010-507	—	7010-507	—
Screw, tappet ...	7010-15	45	—		—		§		§		§	
Locknut ...	5330-87	46	—		—		§		§		§	
Guide ...	7010-595	47	7010-579	47	7010-579	47	7010-595	47	7010-595	47	7010-595	47
Pin, roller ...	7010-172	48	7010-405	48	7010-405	48	7010-172	48	7010-172	48	7010-172	48
Bush, roller ...	7010-11	49	7060-21*	—	7060-21*	—	7010-11	49	7010-11	49	7010-11	49
Roller ...	7010-17	50	7060-20	50	7060-20	50	7010-17	50	7010-17	50	7010-17	50
Plate, cheek ...	—		7060-22	—	7060-22	—	—		—		—	
CAMSHAFT (BPE1B ..)	7060-19	51	§		—		§		—		—	
(BPE2B ..)	—		—		7016-43	51	—		7016-40	51	—	
(BPE3B .. 300/3)	—		—		—		—		—		7017-23	51
(BPE3B .. 400/3)	—		—		—		—		—		7017-24	51
ENDPLATE, ball race ...	7010-555	59	§		§		§		§		§	
ENDPLATE, roller race ...	7010-550	59	§		§		§		§		§	
ENDPLATE, taper roller race†	7010-597	59	§		§		§		§		§	
SCREW, fixing end cover ...	—		—		—		—		—		NS76-18Y1	62A
STUD, endplate... ..	5335-537	63	§		§		§		§		§	
WASHER, spring, for stud ...	5293-57	64	§		§		§		§		§	
NUT, for endplate stud ...	7095-34	65	§		§		§		§		§	
STUD, oil drain ...	—		—		—		—		7008-188	66	7008-237	66
BANJO, oil drain ...	—		—		—		—		NAI-2	67	NAI-2	67
JOINT, oil drain ...	5339-543	68	§		§		5339-304A	68	5339-543	68	5339-543	68
BODY, oil drain ...	7033-133	69	§		§		7010-308	69	7033-133	69	—	
PLUG, oil drain ...	7092-246	71	§		§		—		—		7023-125	71
COVER, blanking (.../3 models)	—		—		—		—		7010-449	72	7010-82B	72
COVER, camshaft end ...	—		—		—		—		—		7010-26A	79
PLUG, end cover ...	—		—		—		—		—		7092-248	80
EXCESS FUEL DEVICE ...	—		—		—		—		7010-345	86	—	
STUD, leak-off nipple ...	—		—		—		7008-3	88	—		—	
NUT, union leak-off ...	—		—		—		7008-15	89	—		—	

† W & Y models only.

* Needle bearing.

|| S6091EL.

‡ † S6091.

§ This denotes the same part number as column 1.



DESCRIPTION	BPE3B65 Q, S, U & W 300/3 & 400/3 S6128	BPE3B65 Q, S, U & W 300/3 & 400/3 S6150	BPE3B90 Q, S, U & W 320/3 & 420/3 S6168X S6168XEL	BPE8B90 Q, S, U & W 310/3 S6176EL	BPE3B90 S, U & W 320/3 & 420/3 S6185X	BPE2B100 T, V & Y 420, 420/3 S6204
WASHER, delivery union ...	5339-138	—	§	§	§	§
HOLDER, delivery valve ...	7010-542	3	§	7010-544 3	7010-545 3	7010-545 3
PEG, spring ...	—	—	§	7009-99 9	7009-99 9	—
SPRING, delivery valve ...	7032-7	10	§	7009-208 10	7010-146 10	7010-146 10
VALVE, delivery ...	7118-229	12	§	7010-586F 12	7010-586 12	7010-586 12
ELEMENT ...	7010-562C	13	§	7010-562S 13	7010-562S 13	7010-562U 13
SPRING, plunger ...	7010-9	20	§	§	§	§
PLATE, spring, lower ...	7009-7	21	§	§	§	§
HOUSING ...	7012-32	22	§	§	7069-2C 22	7012-32 22
JOINT, inlet closing plug ...	5339-174	24	§	§	§	§
CONNECTION, inlet ...	7010-46	25	§	§	§	7010-46A 25
JOINT, inlet connection ...	5339-263	26	§	§	§	§
AIR VENT COCK ...	7010-617A	27	§	—	—	—
UNION, inlet ...	—	—	§	7009-18 30	—	—
ROD, control ...	7017-6	31	§	7017-6B 31	7069-4A 31	7017-6B 31
SLEEVE, control rod ...	—	—	§	—	—	7010-375A 35A
SCREW, control rod sleeve ...	—	—	§	—	—	7028-43 36
NUT, locking c/rod screw ...	—	—	§	—	—	5330-175 37
INSPECTION COVER ASSY. ...	7010-385C	39	§	§	7010-508G 39	7016-38A 39
Gasket ...	7010-27	40	§	§	7069-14 40	7017-27 40
DIPSTICK ...	7010-326	43	§	§	§	—
BUSH, dipstick ...	7010-158	44	§	§	§	—
TAPPET, complete ...	7010-507	—	§	§	§	§
Screw, tappet ...	7010-15	45	§	§	§	§
Locknut ...	5330-87	46	§	§	§	§
Guide ...	7010-595	47	§	§	§	§
Pin, roller ...	7010-172	48	§	§	§	§
Bush, roller ...	7010-11	49	§	§	§	§
Roller ...	7010-17	50	§	§	§	§
CAMSHAFT:						
(BPE2B ..)	—	—	—	—	—	7016-45 51
(BPE3B .. 300/3, 320/3)	7017-18	51	§	—	—	—
(BPE3B .. 400/3, 420/3)	7017-14	51	§	—	—	—
(BPE8B ..)	—	—	—	7069-16 51	—	—
ENDPLATE, ball race ...	7010-555	59	§	7010-412 59	7010-555 59	7010-555 59
ENDPLATE, roller race ...	7010-550	59	§	7010-550B 59	7010-550 59	7010-550 59
ENDPLATE, taper roller race†	7010-597	59	§	7010-597B 59	7010-597 59	7010-597 59
SCREW, fixing end plate ...	—	—	§	NS19-24Z1 62	—	—
STUD, endplate... ...	5335-537	63	§	—	§	§
WASHER, spring, stud/screw...	5293-57	64	§	—	§	§
WASHER, plain, endplate screw	—	—	§	7069-28	—	—
NUT, for endplate stud ...	7095-34	65	§	—	§	§
STUD, oil drain ...	—	7008-237 66	§	7008-188 66	—	7008-188 66
BANJO, oil drain ...	—	NAI-2 67	§	NAI-2 67	—	NAI-2 67
JOINT, oil drain ...	5339-543	68	§	§	§	§
BODY, oil drain ...	7033-133	69	§	§	§	§
PLUG, oil drain... ...	7092-246	71	§	—	§	—
COVER, blanking (.../3 models)	7010-93	72	7010-82B 72	7010-93 72	7010-93 72	7010-449 72
INDICATOR, timing ...	—	—	—	—	—	7010-474G 78
CONNECTION, inlet ...	7027-13	81	§	—	—	—
JOINT, inlet connection ...	7027-17	82	§	—	—	—
BANJO, connection ...	NAI-10	83	§	NAI-9 83	—	—
ADAPTOR, inlet ...	7027-12	84	§	—	—	—
JOINT, inlet adaptor ...	5339-174	85	§	—	—	—
EXCESS FUEL DEVICE ...	—	—	—	7010-345B* 86	7010-345C 86	—
BREATHER ...	—	—	—	—	—	7034-879 ‡ 87
REMOTE CONTROL UNIT ...	—	—	—	7069-26	—	—
STANDARD ITEMS NOT FITTED ...	—	—	—	Nos. 23 & 29	—	No. 23

† W & Y models. * S6168XEL only. ‡ ... 420/S6204 only.
§ This denotes the same part number as column 1.

SERVICE PARTS



FUEL PUMPS
BPE1, 2, 3,
5 & 8B

DESCRIPTION	BPE2B90 S, U & W 100		BPE2B90 S, U & W 100		BPE5B100 S, U & W 400/3, 420 & 420/3		BPE3B80 BPE3B90 BPE3B100 S, U & W 320/3 & 420/3 S6239XEL		BPE3B70 S, U & W 400/3		BPE3B70 BPE3B100 T, V & Y 400/3	
	S6209X		S6214X		S6232XEL		S6239XEL		S6263		S6265	
WASHER, delivery union ...	5339-138	2	§		§		§		§		§	
HOLDER (7-8 mm elements)	—		—		—		7010-544	3	7010-542	3	7010-542	3
(9-10 mm elements)	7010-544	3	§		§		§		—		7010-545	3
PEG, spring ...	7009-99	9	§		§		§		—		—	
SPRING (7-8 mm elements) ...	—		—		—		7009-98	9	7032-7	9	7032-7	9
(9-10 mm elements)	7009-98	10	7009-208	10	7009-208	10	7009-208	10	—		7010-146	10
VALVE (7-8 mm elements) ...	—		—		—		7010-586F	12	7118-229	12	7118-229	12
(9-10 mm elements) ...	7010-586F	12	§		§		§		—		7010-586	12
ELEMENT, 7-0 mm ...	—		—		—		—		7010-562P	13	7010-562P	13
8-0 mm ...	—		—		—		7010-562R	13	—		—	
9-0 mm ...	7010-562S	13	§		—		7010-562S	13	—		—	
10-0 mm ...	—		—		7010-562J	13	7010-562U	13	—		7010-562U	13
SPRING, plunger ...	7010-9	20	§		§		§		§		§	
PLATE, spring, lower ...	7009-7	21	§		§		§		§		§	
HOUSING ...	7016-17	22	§		7012-33	22	7012-32D	22	7012-32	22	7012-32C	22
JOINT, inlet closing plug ...	5339-174	24	§		§		§		§		—	
CONNECTION, inlet ...	7010-46	25	§		§		§		§		§	
JOINT, inlet connection ...	5339-263	26	§		§		§		§		§	
AIR VENT COCK ...	—		—		7010-617A	27	—		—		—	
UNION, inlet ...	7009-18	30	§		§		§		—		—	
ROD, control ...	7016-6	31	§		7018-5A	31	7017-6B	31	7017-6	31	7017-6	31
INSPECTION COVER ASSY. ...	7010-385B	39	§		7010-385E	39	7010-533E	39	7010-385C	39	7010-385C	39
Gasket ...	7016-32	40	§		7018-16	40	7017-27	40	7017-27	40	7017-27	40
DIPSTICK ...	7010-326	43	§		§		—		§		§	
BUSH, dipstick ...	7010-158	44	§		§		—		§		§	
TAPPET, complete ...	7010-507	—	§		§		§		§		§	
Screw, tappet ...	7010-15	45	§		§		§		§		§	
Locknut ...	5330-87	46	§		§		§		§		§	
Guide ...	7010-595	47	§		§		§		§		§	
Pin, roller ...	7010-172	48	§		§		§		§		§	
Bush, roller ...	7010-11	49	§		§		§		§		§	
Roller ...	7010-17	50	§		§		§		§		§	
CAMSHAFT ...	7016-44	51	§		7018-9	51	7017-18*	51	7017-2	51	7017-30	51
	—		—		—		7017-14‡	51	—		—	
ENDPLATE, ball race ...	7010-555	59	§		§		§		§		7010-412	59
ENDPLATE, roller race ...	7010-550	59	§		§		§		§		7010-550B	59
ENDPLATE, taper roller race†	7010-597	59	§		§		§		§		7010-597B	59
SCREW, fixing cover/plate ...	NS75-18Y1	62A	—		—		—		—		NS19-15Z1	62
STUD, endplate... ...	5335-537	63	§		§		§		§		—	
STUD, endplate, long ...	—		—		—		—		7097-20E	63	—	
WASHER, spring, stud/screw...	5293-57	64	§		§		§		§		§	
NUT, for endplate stud ...	7095-34	65	§		§		§		§		—	
STUD, oil drain ...	—		—		7008-188	66	7008-188	66	—		—	
BANJO, oil drain ...	—		—		NAI-2	67	NAI-2	67	—		—	
JOINT, oil drain ...	5339-543	68	§		§		§		§		§	
BODY, oil drain ...	7003-133	69	§		§		§		§		§	
PLUG, oil drain... ...	7092-246	71	§		—		—		§		§	
COVER, blanking (. . /3 models)	—		—		7010-93	72	7010-93	72	7010-93	72	7010-449	73
COVER, camshaft end ...	7010-26	79	—		—		—		—		—	
EXCESS FUEL DEVICE ...	—		—		7010-345B	86	7010-345A	86	—		—	
STANDARD ITEMS NOT FITTED ...	—		—		—		—		—		Nos. 1, 2 & 23	

† W & Y models.

* . . 320/3.

‡ . . 420/3.

§ This denotes the same part number as column 1.



DESCRIPTION	BPE2B70 BPE2B100 T, V & Y 300/3 S6266		BPE1B90 T, V & Y 100 S6268		BPE2B90 BPE3B90 S, U & W 100 & 300/3 S6268		BPE2B70 S, U & W 100 S6269		BPE2B100 T, V & Y 420 S6272		BPE8B90 S, U & W 310/3 S6287EL	
WASHER, delivery union ...	5339-138	2	§		§		§		§		§	
HOLDER (7 mm elements) ...	7010-542	3	—		—		§		—		—	
(9 & 10 mm elements)	7010-545	3	§		§		—		§		§	
SPRING (7 mm elements) ...	7032-7	10	—		—		§		—		—	
(9 & 10 mm elements)	7010-146	10	§		§		—		—		§	
VALVE (7 mm elements) ...	7118-229	12	—		—		§		—		—	
(9 & 10 mm elements)	7010-586	12	§		§		—		§		§	
ELEMENT, 7-0 mm ...	7010-562P	13	—		—		§		—		—	
9-0 mm ...	—		7010-562S	13	7010-562S	13	—		—		7010-562S	13
10-0 mm ...	7010-562U	13	—		—		—		§		—	
SPRING, plunger ...	7010-9	20	7010-9D	20	7010-9D	20	7010-9	20	7010-9	20	7010-9	20
PLATE, spring, lower ...	7009-7	21	§		§		§		§		§	
HOUSING ...	7016-35A	22	7060-2	22	7016-17*	22	7016-17	22	7016-35	22	7069-2C	22
	—		—		7012-32‡	22	—		—		—	
JOINT, inlet closing plug ...	—		5339-174	24	5339-174	24	5339-174	24	5339-174	24	5339-174	24
CONNECTION, inlet ...	7010-46	25	§		§		§		7010-46A	25	7010-46	25
JOINT, inlet connection ...	5339-263	26	§		§		§		§		§	
AIR VENT COCK ...	—		7010-617A	27	7010-617A	27	—		—		—	
UNION, inlet ...	—		7009-18	30	7009-18	30	—		7009-18	30	—	
ROD, control ...	7016-6	31	7060-4	31	7016-6*	31	7016-6	31	7016-6B	31	7069-4B	31
	—		—		7017-6‡	31	—		—		—	
SLEEVE, control rod ...	—		—		—		—		7010-375A	35	—	
SCREW, control rod ...	—		—		—		—		7023-43	36	—	
NUT, locking c/rod screw ...	—		—		—		—		5330-175	37	—	
INSPECTION COVER ASSY. ...	7016-38	39	7010-385A	39	7010-385B*	39	7010-385B	39	7016-38A	39	7010-508G	39
	—		—		7010-385C‡	39	—		—		—	
Gasket ...	7016-32	40	7060-16	40	7016-32*	40	7016-32	40	7016-32	40	7069-14	40
	—		—		7017-27‡	40	—		—		—	
DIPSTICK ...	—		7010-326	43	7010-326	43	7010-326	43	—		7010-326	43
BUSH, dipstick ...	—		7010-158	44	7010-158	44	7010-158	44	—		7010-158	44
TAPPET, complete ...	7010-507	—	§		§		§		§		§	
Screw, tappet ...	7010-15	45	§		§		§		§		§	
Locknut ...	5330-87	46	§		§		§		§		§	
Guide ...	7010-595	47	§		§		§		§		§	
Pin, roller ...	7010-172	48	§		§		§		§		§	
Bush, roller ...	7010-11	49	§		§		§		§		§	
Roller ...	7010-17	50	§		§		§		§		§	
CAMSHAFT ...	7016-41	51	7060-3	51	7016-1*	51	7016-1	51	7016-42	51	7069-29	51
	—		—		7017-1‡	51	—		—		—	
ENDPLATE, ball race ...	7010-412	59	7010-555	59	7010-555	59	7010-555	59	7010-555	59	7010-412	59
ENDPLATE, roller race ...	7010-550B	59	7010-550	59	7010-550	59	7010-550	59	7010-550	59	7010-550B	59
ENDPLATE, taper roller race†	7010-597B	59	7010-597	59	7010-597	59	7010-597	59	7010-597	59	7010-597B	59
SCREW, endplate ...	NS19-15Z1	62	—		—		—		—		NS19-24Z1	62
WASHER, spring, endplate screw ...	—		—		—		—		—		7069-28	—
STUD, endplate... ...	—		5335-537	63	5335-537	63	5335-537	63	5335-537	63	—	
WASHER, spring, stud/screw...	5293-57	64	§		§		§		§		§	
NUT, for endplate stud ...	—		7095-34	65	7095-34	65	7095-34	65	7095-34	65	—	
STUD, oil drain... ...	—		—		—		—		7008-188	66	7008-188	66
BANJO, oil drain ...	—		—		—		—		NAI-2	67	NAI-2	67
JOINT, oil drain ...	—		5339-543	68	5339-543	68	5339-543	68	5339-543	68	5339-543	68
BODY, drain level ...	7003-133	69	§		§		§		§		§	
PLUG, oil drain... ...	7092-246	71	§		§		§		—		—	
COVER, blanking (. . . /3 models)	7010-449	72	—		7010-93	72	—		—		7010-93	72
INDICATOR, timing ...	—		—		—		—		7010-474G	78	—	
CONNECTION, inlet ...	—		—		—		—		—		7027-13	81
JOINT, inlet connection ...	—		—		—		—		—		7027-17	82
BANJO, connection ...	—		—		—		—		—		NAI-9	83
ADAPTOR, inlet ...	—		—		—		—		—		7027-12	84
EXCESS FUEL DEVICE ...	—		—		—		—		—		7010-463A	86
BREATHER ...	—		—		—		—		7034-879	87	—	
STANDARD ITEMS NOT FITTED ...	Nos. 1, 2 & 23		—		—		—		—		Nos. 28 & 29	

† W & Y models.

* BPE2B .. 100 ..

‡ BPE3B .. 300/3 ..

§ This denotes the same part number as column 1.

SERVICE PARTS



FUEL PUMPS
BPE1, 2, 3,
5 & 8B

DESCRIPTION	BPE2B70 S, U & W 100 & 110		BPE8B80 S, U & W 320 & 410		BPE2B90 U & W 100		BPE8B80 U & W 310 & 420		BPE2B70W BPE3B70W 100, 200, 300/3 & 400/3 S6424		BPE2B75W 100	
	S6304		S6312E		S6352XE		S6362E				S6470	
WASHER, delivery union ...	5339-138	2	§		§		§		§		§	
HOLDER, delivery valve ...	7010-542	3	§		7010-544	3	7010-545	3	7010-542	3	7010-542	3
PEG, spring ...	—		—		7009-99	9	—		—		—	
SPRING, delivery valve ...	7032-7	10	§		7009-238	10	7010-146	10	7032-7	10	7032-7	10
VALVE, delivery ...	7118-229	12	§		7010-586F	12	7010-586	12	7118-229	12	7118-229	12
ELEMENT ...	7010-562P	13	7010-562R	13	7010-562S	13	7010-562R	13	7010-562D	13	7010-562Q	13
SPRING, plunger ...	7010-9	20	§		—		§		§		§	
PLATE, spring, lower ...	7009-7	21	§		—		§		§		§	
HOUSING ...	7016-17	22	7069-2D	22	7016-17	22	7069-2D	22	7016-17**	22	7016-17	22
	—		—		—		—		7012-32	22	—	
JOINT, inlet closing plug ...	5339-174	24	§		§		§		§		§	
CONNECTION, inlet ...	7010-46	25	§		§		§		§		§	
JOINT, inlet connection ...	5339-263	26	§		§		§		§		§	
UNION, inlet ...	7009-18	30	§		§		§		§		§	
ROD, control ...	7016-6*	31	7069-4A	31	7016-6	31	7069-4A	31	7016-6**	31	7016-6	31
	7016-6B‡	31	—		—		—		7017-6	31	—	
SLEEVE, control rod ...	7010-509‡	35	—		—		—		—		—	
SCREW, control rod ...	7033-205‡	36	—		—		—		—		—	
NUT, locking c/rod screw ...	5330-136‡	37	—		—		—		—		—	
COVER, control rod sleeve ...	7033-204‡	38	—		—		—		—		—	
INSPECTION COVER ASSY. ...	7010-385B	39	7010-508G	39	7010-385B	39	7010-508G	39	7010-385B**	39	7010-385B	39
	—		—		—		—		7010-385C	39	—	
Gasket ...	7016-32	40	7069-14	40	7016-32	40	7069-14	40	7016-32**	40	7016-32	40
	—		—		—		—		7017-27	40	—	
DIPSTICK ...	7010-326	43	—		§		—		§		§	
BUSH, dipstick ...	7010-158	44	—		§		—		§		§	
TAPPET, complete ...	7010-507	—	§		§		§		§		§	
Screw, tappet ...	7010-15	45	§		§		§		§		§	
Locknut ...	5330-87	46	§		§		§		§		§	
Guide ...	7010-595	47	§		§		§		§		§	
Pin, roller ...	7010-172	48	§		§		§		§		§	
Bush, roller ...	7010-11	49	§		§		§		§		§	
Roller ...	7010-17	50	§		§		§		§		§	
CAMSHAFT:												
(BPE2B .. 100, 110) ...	7016-1	51	—		7016-46	51	—		7016-1	51	7016-21	51
(BPE2B .. 200) ...	—		—		—		—		7016-2	51	—	
(BPE3B .. 300/3) ...	—		—		—		—		7017-1	51	—	
(BPE3B .. 400/3) ...	—		—		—		—		7017-2	51	—	
(BPE8B ..) ...	—		7069-30	51	—		7069-31	51	—		—	
ENDPLATE, ball race ...	7010-555	59	§		§		§		—		—	
ENDPLATE, roller race ...	7010-550	59	§		§		§		—		—	
ENDPLATE, taper roller race†	7010-597	59	§		§		§		—		—	
SCREW, fixing end cover ...	—		—		NS76-18Y1	62A	—		—		—	
STUD, endplate... ...	5335-537	63	§		§		§		—		—	
WASHER, spring, stud/screw...	5293-57	64	§		§		§		—		—	
NUT, for endplate stud ...	7095-34	65	§		§		§		—		—	
STUD, oil drain ...	7008-188	66	§		§		§		—		—	
BANJO, oil drain ...	NAI-2	67	§		§		§		—		—	
JOINT, oil drain ...	5339-543	68	§		§		§		—		—	
BODY, drain level ...	7033-133	69	§		§		§		—		—	
PLUG, oil drain ...	7092-246	71	§		§		§		—		—	
COVER, blanking ...	—		7010-93	72	—		7010-93	72	7010-93	72	—	
COVER, end ...	—		—		7010-26	79	—		—		—	
CONNECTION, inlet ...	—		—		—		—		7027-13	81	—	
JOINT, inlet connection ...	—		—		—		—		7027-17	82	—	
BANJO, connection ...	—		—		—		—		NAI-10	83	—	
ADAPTOR, inlet ...	—		—		—		—		7027-12	84	—	
JOINT, adaptor ...	—		—		—		—		5339-174	85	—	
EXCESS FUEL DEVICE ...	—		7010-345	86	7010-345	86	7010-345	86	—		—	
STANDARD ITEMS NOT FITTED ...	—		—		—		—		—		Nos. 53 & 54	

† W & Y models.

* BPE2B .. 100.

‡ BPE2B .. 110 ..

**BPE2B ..

||BPE3B ..

§ This denotes the same part number as column I.



DESCRIPTION	BPE2B75W BPE3B75W 100, 300/3 & 400/3 S6471		BPE3B75W 300/3 & 400/3 S6472		BPE3B100W 320 & 420 S6519		BPE3B100W 420/3 S6572EL		BPE1B60Y 101 S6629	
WASHER, delivery union ...	5339-138	2	§		7008-561	2	7008-561	2	5339-138	2
HOLDER, delivery valve ...	7010-542	3	§		7010-545	3	7010-545	3	7010-542	3
SPRING, delivery valve ...	7032-7	10	§		7010-146	10	7010-146	10	7032-7	10
VALVE, delivery ...	7118-229	12	§		7010-586	12	7010-586	12	7118-229	12
ELEMENT ...	7010-562Q	13	§		7010-562U	13	7010-562U	13	7010-562M	13
SPRING, plunger ...	7010-9	20	§		§		§		7010-407	20
PLATE, spring, lower ...	7009-7	21	§		§		§		7009-184	21
HOUSING (BPE1B) ...	—		—		—		—		7060-2	22
(BPE2B) ...	7016-17	22	—		—		—		—	
(BPE3B) ...	7012-32	22	§		7012-32D	22	7012-32D	22	—	
JOINT, inlet closing plug ...	5339-174	24	§		§		§		§	
CONNECTION, inlet ...	7010-46	25	§		§		§		§	
JOINT, inlet connection ...	5339-263	26	§		§		§		§	
UNION, inlet ...	—		—		—		—		7009-18	30
ROD, control (BPE1B) ...	—		—		—		—		7060-4	31
(BPE2B) ...	7016-6A	31	—		—		—		—	
(BPE3B) ...	7017-6A	31	7017-6	31	7017-6B	31	7017-6B	31	—	
SLEEVE, control rod ...	—		—		7010-509	35	—		—	
SCREW, control rod ...	—		—		7033-205	36	—		—	
NUT, locking c/rod screw ...	—		—		5330-136	37	—		—	
COVER, c/rod sleeve ...	—		—		7033-204	38	—		—	
INSPECTION COVER ASSY.:										
(BPE1B) ...	—		—		—		—		7010-385A	39
(BPE2B) ...	7010-385B	39	—		—		—		—	
(BPE3B) ...	7010-385C	39	7010-385C	39	7010-533G	39	7010-533G	39	—	
Gasket (BPE1B) ...	—		—		—		—		7060-16	40
(BPE2B) ...	7016-32	40	—		—		—		—	
(BPE3B) ...	7017-27	40	7017-27	40	7017-27	40	7017-27	40	—	
DIPSTICK ...	7010-326	43	§		—		—		§	
BUSH, dipstick ...	7010-158	44	§		—		—		§	
TAPPET, complete ...	7010-507	—	§		§		§		7010-406	—
Screw, tappet ...	7010-15	45	§		§		§		—	
Locknut ...	5330-87	46	§		§		§		—	
Guide ...	7010-595	47	§		§		§		7010-579	47
Pin, roller ...	7010-172	48	§		§		§		7010-405	48
Bush, roller ...	7010-11	49	§		§		§		§	
Roller ...	7010-17	50	§		§		§		§	
CAMSHAFT:										
(BPE1B) ...	—		—		—		—		7060-3	51
(BPE2B .. 100) ...	7016-21	51	—		—		—		—	
(BPE3B .. 300/3 .. 320/3) ...	7017-18	51	§		§		§		—	
(BPE3B .. 400/3 .. 420/3) ...	7017-14	51	§		§		§		—	
ENDPLATE ...	7010-597	59	§		§		§		§	
STUD, endplate... ...	5335-537	63	§		§		§		§	
STUD, endplate, long ...	—		7097-20E	63	—		—		—	
WASHER, spring, for stud ...	5293-57	64	§		§		§		§	
NUT, for endplate stud ...	7095-34	65	§		§		§		§	
STUD, oil drain ...	—		—		7008-188	66	7008-188	66	—	
BANJO, oil drain ...	—		—		NAI-2	67	NAI-2	67	—	
JOINT, oil drain ...	5339-543	68	§		§		§		§	
BODY, drain level ...	7033-133	69	§		§		§		§	
PLUG, oil drain ...	7092-246	71	§		—		—		§	
COVER, blanking (. / 3 models)	7010-93	72	§		—		§		—	
CONNECTION, inlet ...	—		—		7027-13	81	7027-13	81	—	
JOINT, inlet connection ...	—		—		7027-17	82	7027-17	82	—	
BANJO, connection ...	—		—		NAI-10	83	NAI-10	83	—	
ADAPTOR, inlet ...	—		—		7027-12	84	7027-12	84	—	
JOINT, adaptor ...	—		—		5339-174	85	5339-174	85	—	
EXCESS FUEL DEVICE ...	—		—		—		7010-345F	86	—	
STANDARD ITEMS NOT FITTED ...	Nos. 53 & 54		Nos. 53 & 54		—		—		Nos. 53 & 54	

§ This denotes the same part number as column 1.



ELEMENT & VALVE DETAILS

STANDARD ELEMENTS WITH 20.0 mm PITCH HELIX							DELIVERY VALVES, ETC.		
PLUNGER DIAMETER mm	ELEMENTS L.H. Helix for Assembly Nos. 300, 300/3, 310, 310/3, 400, 400/3 , 410 & 410/3			ELEMENTS R.H. Helix for Assembly Nos. 320, 320/3, 420 & 420/3			DELIVERY VALVE	DELIVERY VALVE HOLDER	DELIVERY VALVE SPRING
	GROOVED HELIX	NORMAL HELIX	IDENT. No.	GROOVED HELIX	NORMAL HELIX	IDENT. No.			
6.0	7010-562M	7009-41	B1/6	7010-562B	7010-58	B9/2	7118-229	7010-542	7032-7
6.5	7010-562N	7009-42	B1/5	7010-562C	7010-59	B9/3	7118-229	7010-542	7032-7
7.0	7010-562P	7009-43	B1/1	7010-562D	7010-60	B9/4	7118-229	7010-542	7032-7
7.5	7010-562Q	7009-44	B1/7	7010-562E	7010-61	B9/5	7118-229	7010-542	7032-7
8.0	7010-562R	7009-45	B1/2	7010-562F	7010-62	B9/6	7118-229	7010-542	7032-7
9.0	7010-562S	7009-46	B1/3	7010-562H	7010-63	B9/7	7010-586	7010-545	7010-146
10.0	7010-562U	7009-47	B1/4	7010-562J	7010-64	B9/8	7010-586	7010-545	7010-146

ALTERNATIVE ELEMENTS WITH 14.89 mm PITCH HELIX							DELIVERY VALVES, ETC.		
PLUNGER DIAMETER mm	ELEMENTS L.H. Helix for Assembly Nos. 300, 300/3, 310, 310/3, 400, 400/3, 410 & 410/3			ELEMENTS R.H. Helix for Assembly Nos. 320, 320/3, 420 & 420/3			DELIVERY VALVE	DELIVERY VALVE HOLDER	DELIVERY VALVE SPRING
	GROOVED HELIX	NORMAL HELIX	IDENT. No.	GROOVED HELIX	NORMAL HELIX	IDENT. No.			
6.0	7010-609B	7010-118	B5/2	7010-609L	7010-126	B10/2	7118-229	7010-542	7032-7
6.5	7010-609C	7010-119	B5/3	7010-609M	7010-127	B10/3	7118-229	7010-542	7032-7
7.0	7010-609D	7010-120	B5/4	7010-609N	7010-128	B10/4	7118-229	7010-542	7032-7
7.5	7010-609E	7010-121	B5/5	7010-609P	7010-129	B10/5	7118-229	7010-542	7032-7
8.0	7010-609F	7010-122	B5/6	7010-609Q	7010-130	B10/6	7118-229	7010-542	7032-7
9.0	7010-609H	7010-123	B5/7	7010-609S	7010-131	B10/7	7010-586	7010-545	7010-146
10.0	7010-609J	7010-124	B5/8	7010-609T	7010-132	B10/8	7010-586	7010-545	7010-146

Grooved helix elements supersede and are interchangeable with normal helix elements and should be called for on all service replacements.



C.A.V. WORLD SERVICE HEADQUARTERS

Warple Way, Acton, London, W.3

Telephone: Shepherds Bush 3111

Telegrams: Vanteria London, Telex 27881

HOME SERVICE DEPOTS

LONDON AREA

C.A.V. LTD.
Southend Road
Woodford Green
Essex

Telephone: Crescent 6711
Telegrams: Lucaserv, Woodford Green
Telex 24358

C.A.V. LTD.
Dordrecht Road
Acton, W.3

Telephone: Shepherds Bush 3160
Telegrams: Lucaserv, London
Telex 21386

SOUTH-EASTERN AREA

C.A.V. LTD.
85 Old Shoreham Road
Hove 4

Telephone: Hove 772341
Telegrams: Lucaserv, Hove
Telex 87246

SOUTH-WESTERN AREA

C.A.V. LTD.
345 Bath Road
Bristol 4

Telephone: Bristol 79311
Telegrams: Lucaserv, Bristol
Telex 44245

EASTERN AREA

C.A.V. LTD.
Newmarket Road
Cambridge

Telephone: Cambridge 51251
Telegrams: Lucaserv, Cambridge
Telex 81139

MIDLAND AREA

C.A.V. LTD.
Great Hampton Street
Birmingham 18

Telephone: Central 5050
Telegrams: Lucaserv, Birmingham
Telex 33103 & 33528

NORTH-EASTERN AREA

C.A.V. LTD.
64 Roseville Road
Leeds 8

Telephone: Leeds 28591
Telegrams: Lucaserv, Leeds
Telex 55172

C.A.V. LTD.
Saltmeadows Road
Gateshead, 8

Telephone: Gateshead 73851
Telegrams: Lucaserv, Gateshead
Telex 53147

NORTH-WESTERN AREA

C.A.V. LTD.
450-470 Edge Lane
Liverpool 13

Telephone: Stonycroft 4721
Telegrams: Lucaserv, Liverpool
Telex 62430

C.A.V. LTD.
Talbot Road
Stretford
Manchester

Telephone: Longford 1101
Telegrams: Lucaserv, Manchester
Telex 66715

CENTRAL & SOUTH WALES AREA

C.A.V. LTD.
54A Penarth Road
Cardiff

Telephone: Cardiff 28361
Telegrams: Lucaserv, Cardiff
Telex 49325

SCOTTISH AREA

C.A.V. LTD.
4-24 Grant Street
St. George's Road
Glasgow, C.3

Telephone: Douglas 6591-7
Telegrams: Lucaserv, Glasgow
Telex 77381

C.A.V. LTD.
60 Stevenson Road
Gorgie
Edinburgh 11

Telephone: Donaldson 2311
Telegrams: Lucaserv, Edinburgh
Telex 72161

EIRE & NORTHERN IRELAND AREA

C.A.V. LTD.
Portland Street North
North Circular Road
Dublin 1

Telephone: Dublin 46195
Telegrams: Lucaserv, Dublin
Telex 235

C.A.V. LTD.
Bachelors Quay
Cork

Telephone: Cork 21981
Telegrams: Lucaserv, Cork

C.A.V. LTD.
51-55 Upper Library St.
Belfast 1

Telephone: Belfast 25617
Telegrams: Lucaserv, Belfast
Telex 74519

C.A.V. LTD.
199 Duncreggan Road
Londonderry

Telephone: Londonderry 4621
Telegrams: Lucaserv, Londonderry

EXPORT SERVICE ORGANIZATION

JOSEPH LUCAS (EXPORT) LTD.

46 Park Street, London, W.1

Telephone: Grosvenor 4491
Telegrams: Lucaslond, London, Telex

Cables: Lucaslond, London, W.1
Telex: 25386

C.A.V. WORLD SERVICE TRAINING CENTRE

155 Merton Road, Wandsworth, London, S.W.18

C.A.V. LIMITED · ACTON · LONDON W.3

Telephone: SHEPHERDS BUSH 3111

Telegrams: VANTERIA LONDON, TELEX 27881

PRINTED IN ENGLAND

Publication No. 3136/3

(December, 1960)